

CONTROLLED/DISTRIBUTION CODE  
 1 2 3 4 5 6 7 8 9 10 11 12 13 14 15 16 17 18 19 20  
 21 22 23 24 25 26 27 28 29 30 31 32 33 34 35 36  
 37 38 39 40 41 42 43 44 45 46 47 48 49 50 51 52  
 53 54 55 56 57 58 59 60 61 62 63 64 65 66 67 68  
 69 70 71 72 73 74 75 76 77 78 79 80 81 82 83 84  
 85 86 87 88 89 90 91 92 93 94 95 96 97 98 99  
 100 101 102 103 104 105 106 107 108 109 110 111  
 112 113 114 115 116 117 118 119 120 121 122 123  
 124 125 126 127 128 129 130 131 132 133 134 135  
 136 137 138 139 140 141 142 143 144 145 146 147  
 148 149 150 151 152 153 154 155

REV. LET.	REVISION DESCRIPTION	DRAWN BY	ECN NO.	DA
045		B.E.	5170	11-8

**QUALITY CONTROL PROVISIONS:**

Requirements shall be in accordance with Raytheon's Mat'l. & Supply Specifications 72 and as specified herein. The procuring activity reserves the right to perform inspection in accordance with this specification and to return shipments that fail, and also the right to return individual failed devices regardless of whether or not the sample inspection is passed.

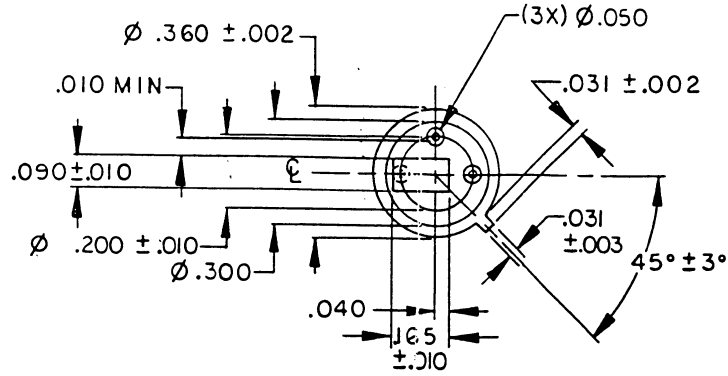

CONTROLLED COPY

**NOTES:**

1. DIE ATTACH PADDEL, FLATNESS  $\leq .002$ ", TILT  $\leq 3^\circ$ .
2. FOR INSPECTION CRITERIA SEE M & S NO. 72.
3. POST HEIGHT AND FLANGE THICKNESS ARE MAJOR ACCEPTANCE LEVELS.

CAT NO.	NICKEL PLATE ( $\mu$ " )		GOLD PLATE ( $\mu$ " )		LEAD LNTH
	PRE-FUSED	FINAL	BETA SCOPE	MIN D/A THRU LEAD	
7430	→		30	FULL	0.500 0.560
7330			30	FULL	1.500 1.562

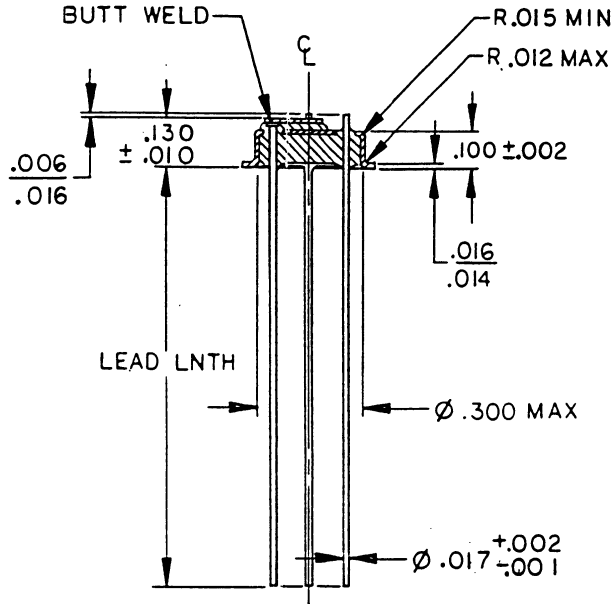

C500432

ALL DIMENSIONS IN INCHES UNLESS OTHERWISE SPECIFIED.

DRAWN ANGELO SILVA 819-7			CHECKED R 202, 11-1-27			APPROVED FOR PRODUCTION		
FINISH			MATERIAL KOVAR			SPECIFICATION M & S NO. 7		
TOLERANCE UNLESS OTHERWISE SPECIFIED			HEADER, TO-5			ISOLETED COLLECTOR (SHORT-F		
1/16 DECIMAL - .008						DWG NO.		
1/32 DECIMAL - .010								
1/64 DECIMAL - .015								
FRACTIONAL								
ANGULAR - 0° 30'								
SURFACE ROUGHNESS								

SSM P/N HDR00536